

ITM – Integrated Turbine Meter

HIGHLY ACCURATE AND RELIABLE
LIQUID MEASUREMENT



Turbines, Inc. is the leader in the design and manufacture of reliable and accurate turbine flow metering equipment, electronic monitors, and accessories. All products are engineered, manufactured, and calibrated using premium quality materials by skilled tradesman with state-of-the-art equipment.

Turbines, Inc. maintains a team of dedicated engineers, technicians, and application specialists, who are on-call to assist with product/application guidance, technical assistance, and special configurations or modifications.

Specifications

Specifications	
Performance	
Linearity	+/- 1.0% over standard flow range
Repeatability	+/- 0.1% over standard flow range
Operating Temperature	-22° F to +150° F
Flow Rate	3 to 30 gpm 5 to 50 gpm
Materials	
Meter Body	316 Stainless steel
Rotor Supports	316 Stainless steel
Meter Rotor	7/8" 416 Stainless steel 1" CD4MCu
Rotor Shaft	Tungsten Carbide
Sleeve Bearings	Tungsten Carbide
Additional Information	Full line of calibrated, Retrofit Kits are available Factory refurbishment is available UV Resistant Enclosure PA66 GF20
Connection	1" FNPT
Certifications	ISO9001, NIST traceable calibration, IP67



General Arrangement

Meter Size	A in (mm)	B in (mm)	C in (mm)	D End Fitting
7/8"	2.375 (60.33)	2.86 (72.6)	5.50 (139.7)	1" FNPT
1"	2.375 (60.33)	2.86 (72.6)	5.50 (139.7)	

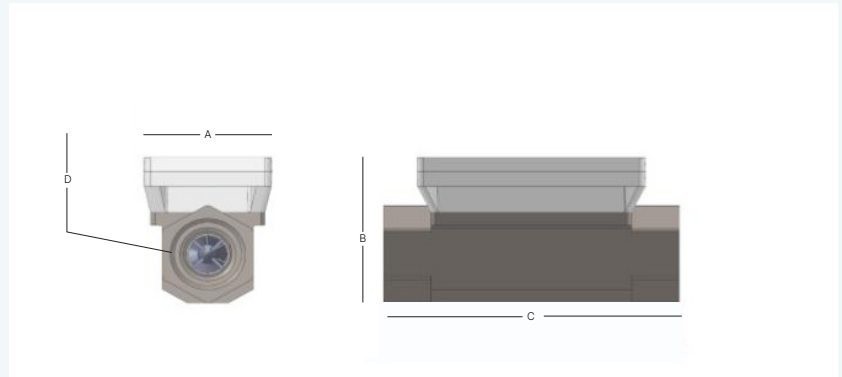

Meter Size	Nominal Flow Range Gallons (Liters) Per Minute	
	Minimum Linear	Maximum Linear
7/8"	3 (11.3)	30 (113)
1"	5 (18.9)	50 (189)

Electronics	
Total Display	Accumulative and Batch
Readout Totals	8 Digits
Decimal Locations	0, 1, 2, X10, X100
Total Units	Gallons (GAL), Liters (LIT), Cubic Meters (M3), Custom
Rate Display	
Readout Rate	6 Digits
Decimal Locations	0, 1, 2, X10, X100
Rate Units	Seconds (/S), Minute (/M), Hour (/H), Day (/D)

Service

Our dedicated staff offers complete support and recertification for flow meters — whether our own or a competitor's brand. Our calibration services are performed by our trained technicians using the latest testing equipment.

Turbines, Inc. maintains extensive inventories in multiple locations to facilitate rapid, industry leading deliveries.

Worldwide Support

We serve customers globally with offices in Altus, OK; Seneca, SC; Odessa, TX; Cranston, RI; and Edmonton, Alberta, Canada.



Turbines, Inc. products are proudly made in the U.S.A.



15935 Highway 283 N.
Altus, Oklahoma 73522, USA
Tel: +1-580-477-3067
www.turbinesincorporated.com



112 Lumber Ln.
Seneca, SC 29672 USA
Tel: +1-864-882-4544
www.turbinesincorporated.com



960 South Meadow Ave.
Odessa, TX 79761 USA
Tel: +1-432-333-4800
www.turbinesodessa.com



800 Wellington Avenue
Cranston, RI 02910, USA
Tel: +1-401-461-6366
www.primaryflowsignal.com



2236 80th Avenue NW,
Edmonton, AB T6P 1N2
Tel: 877-661-3569
www.pfscanada.ca